

REED SWITCH CONTACT FORM C TRANSFER

MKC-27701

Reed relays, Security, Limit switching, Telecoms, Office equipment (up to 10kHz)

Switching current 3 A

Switching power 120 W, VA

Switching voltage 150 V

Pull in range 60...85 AT



Dimensions



Electrical Data

Release range, AT, min	20
Carry current, A	3
Breakdown voltage	
V, not less, AC/DC	180/250
Resetting Ratio	0,35...0,95
Contact resistance, Ω, not more	0,3
Operating time including bounce, ms, not more	3
Release time including bounce ms, not more	3
Capacitance, pF, not more	-
Insulation resistance, GΩ, not less	0,2 (N.C.) 0.5 (N.O.)
Operating frequency, Hz	100
Switching current frequency, kHz, not more	10

Environmental Data

Contact material	Mo
Life expectancy, switching cycles x10 ⁶ max load power... low load power	0,01...1
Vibration (1...2000 Hz), g, not more	10
Resonant frequency, Hz	2000
Shock (1±0,3) ms, g, not more	150
Weight, g, not more	1,5
Operating temperature, °C	-60...85
Humidity, %, not more	98

Certificates



RoHS

Test Coil

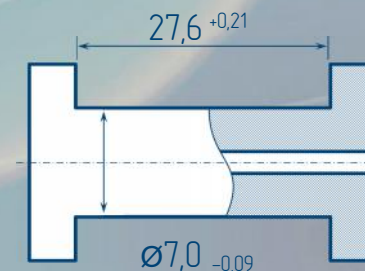

5000 turns, wire Ø0,08 mm
coil resistance 450

Order information

Delivery of reed switches with formed and/or cropped leads and with narrow pull in ranges is available by agreements.



RYAZAN METAL CERAMICS INSTRUMENTATION PLANT, JSC
51V, Novaya St., 390027, Ryazan, Russia
Phone: +7 (4912) 240-234, Факс: +7 (4912) 240-234 E-mail: ives@rmcip.ru

Update on 18 April 2014

